

pop-up display setup guide

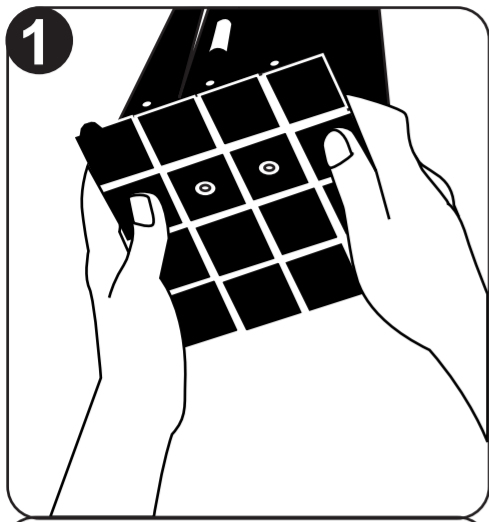

1 make sure that the white location marker is at the top of the frame

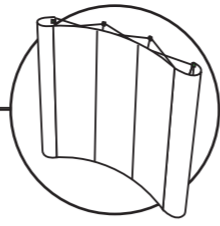
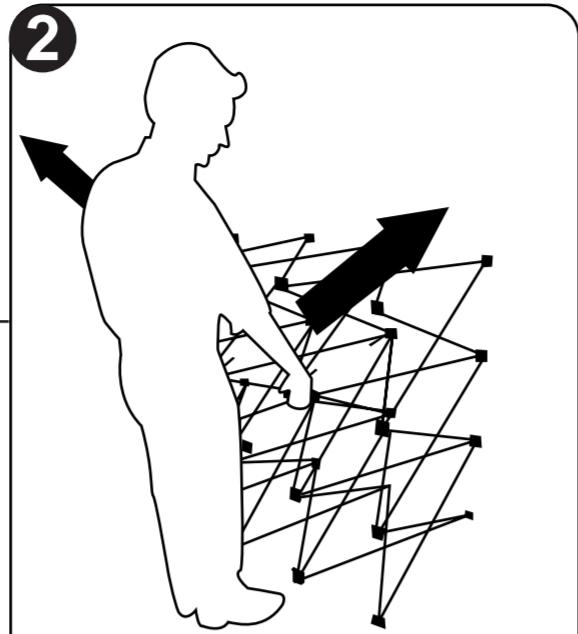

2 extend arms upwards & outwards

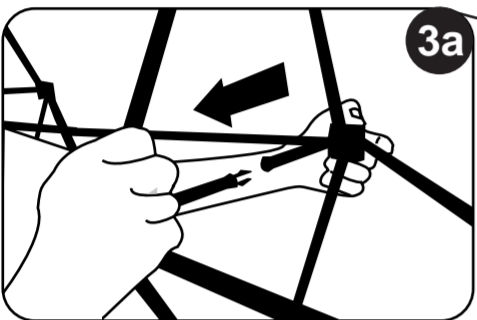

3a pull joints together

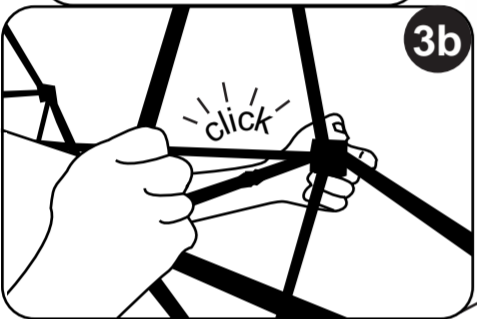

3b

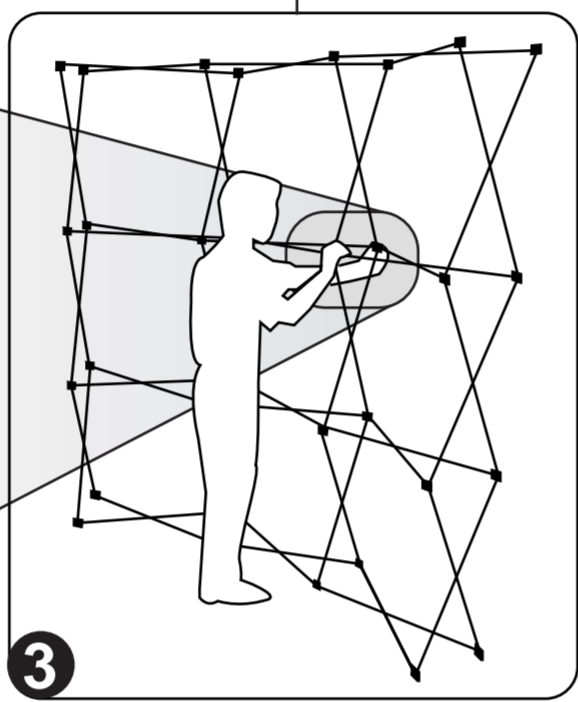

3

applying your graphics

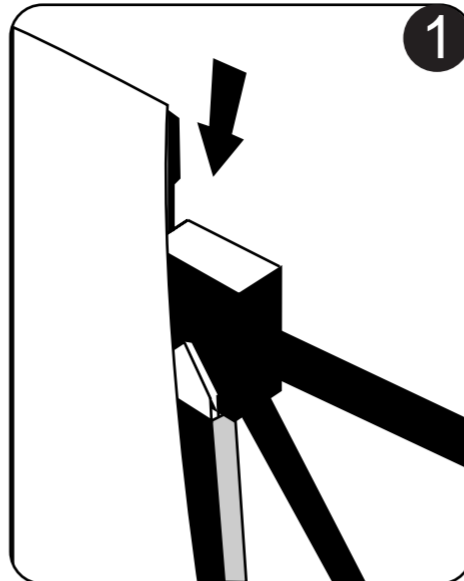
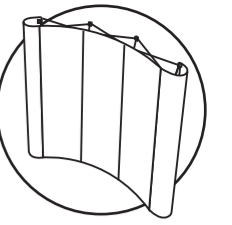

1 place the 'hanger' above the node and gently slide it into place in a downward motion

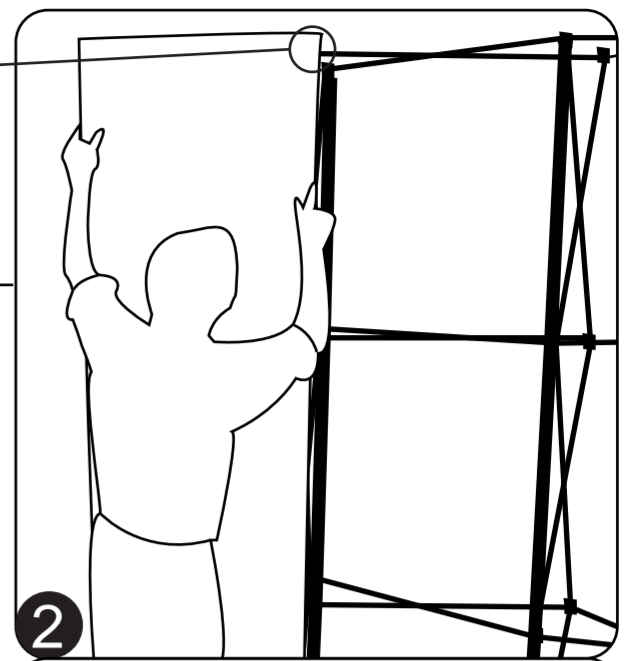
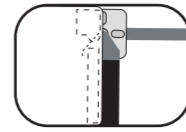

2

apply this technique on the corner graphic but gently curve it around the back of the pop-up. connect the other side of the graphic in exactly the same way

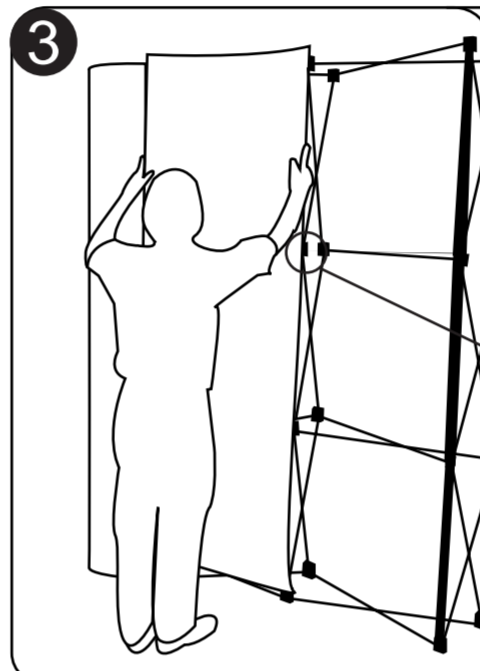

3

do the same to all the graphics running fingers down the side whilst applying the graphic to the magnetic bars with the thumb

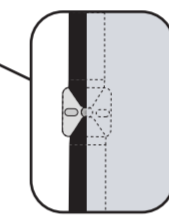

do not force the graphic to curve or apply too much of a bend as this could lead to the graphic becoming creased and therefore un-useable

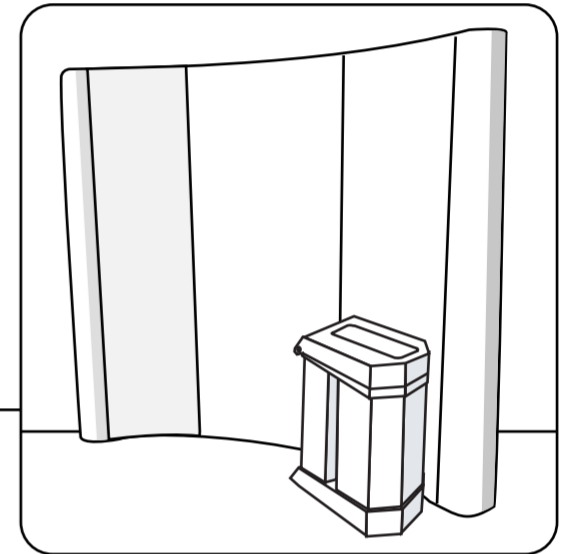

adding lights

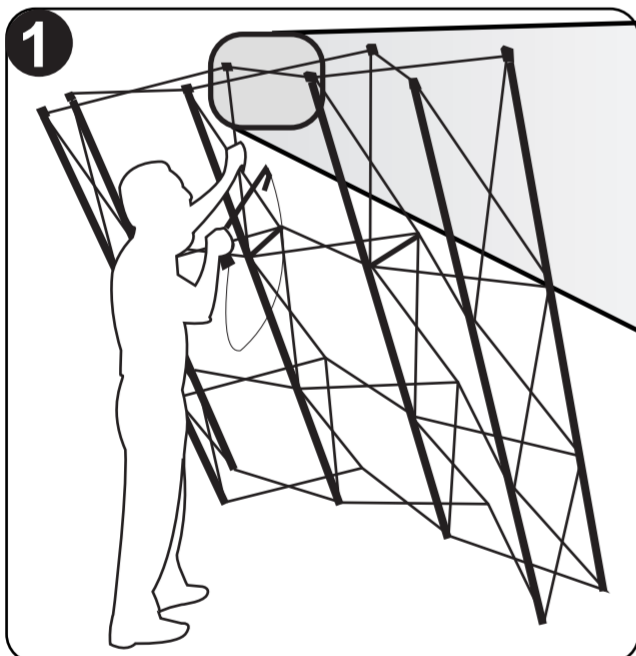
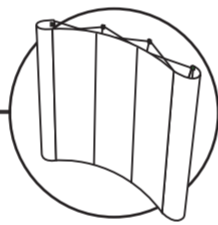

1 to add lighting, firstly pull the frame towards you holding the frame itself. hold the light in position above, lift it over the top of the frame and pull it under the first bar and over the second

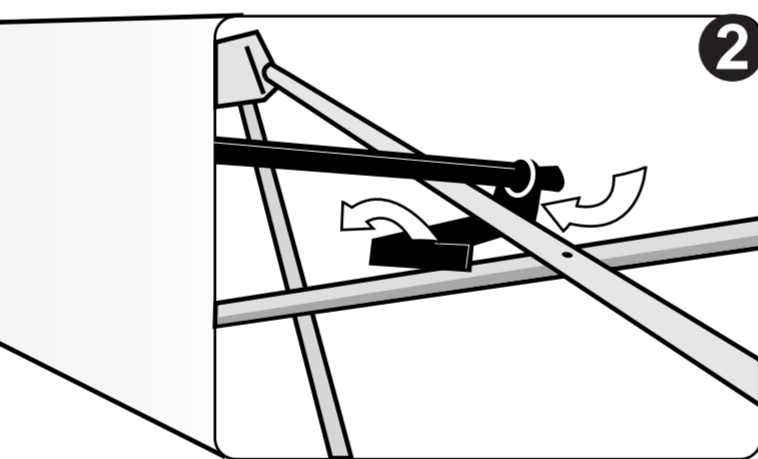

2

taking down your pop-up

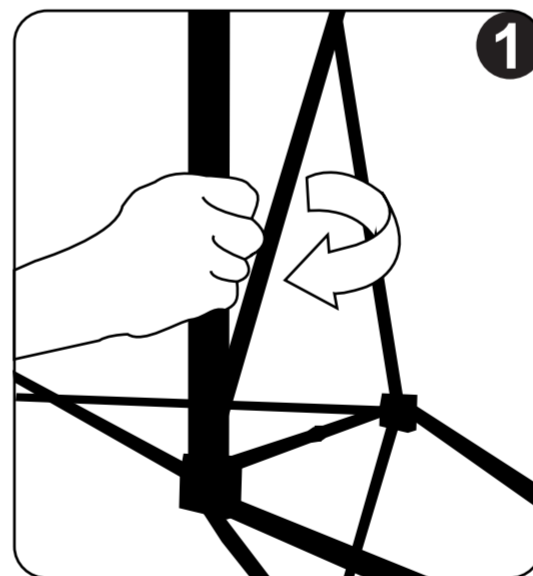
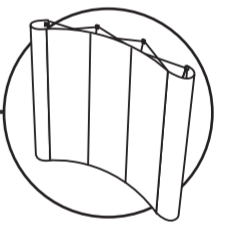

1 to remove the magnetic bars away from the frame, gently twist them in a clockwise direction. This should fully release them from the plastic nodes on which they were attached.

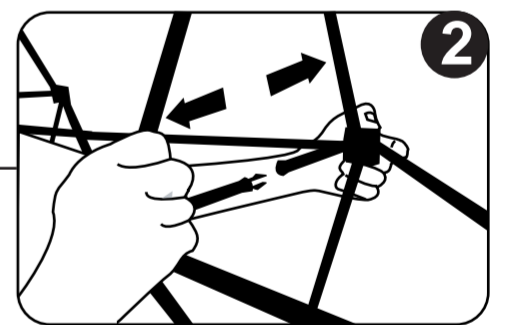

2 unplug the two joints

removing your graphics

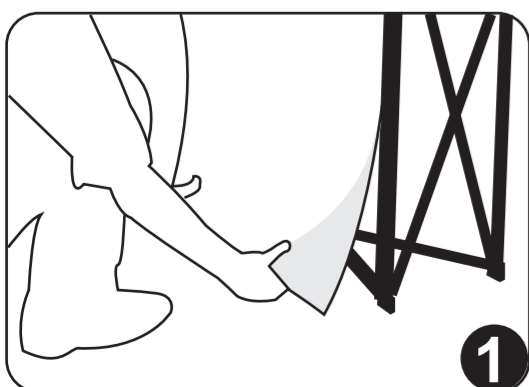
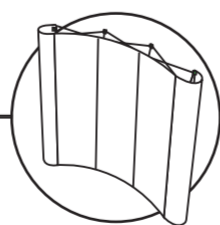

1 simply 'peel' the graphic away from the magnetic bars starting at the bottom and working upwards

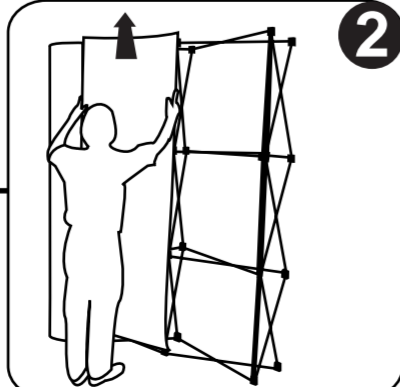

2 gently lift the graphic from off of the frame

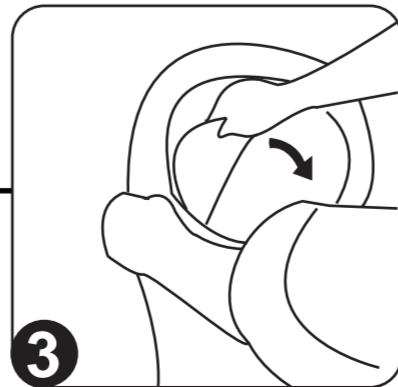

3 proceed to roll the graphic, drawing it in from the middle

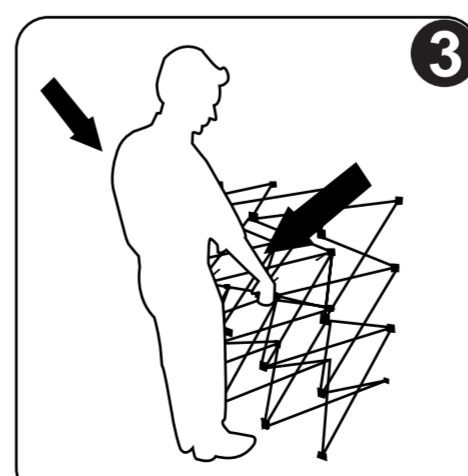

4 collapse the frame, holding only to stop the frame from collapsing too quickly

place the graphics, the pop-up and magnetic bars in the appropriate compartments within the bin.

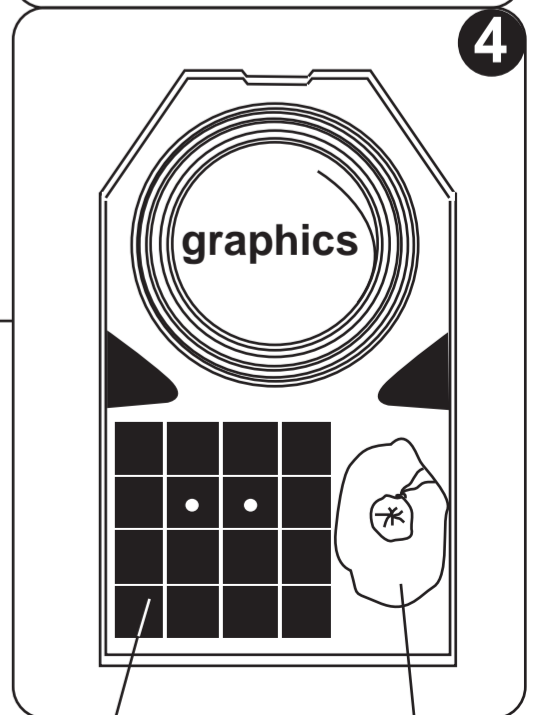

pop-up

magnetic bars